

6 - TREE WELLS

NOTES:

1. PROJECT ENGINEER TO FIELD VERIFY EXTENTS OF EXISTING CURB AND GUTTER, SIDEWALK, AND DRIVEWAYS FOR REMOVAL AND REPLACEMENT.
2. ALL GRADING AND PEDESTRIAN IMPROVEMENTS SHALL COMPLY WITH ADA REQUIREMENTS. COORDINATE WITH PROJECT ENGINEER TO FIELD VERIFY LINES, GRADES AND LEVELS.
3. ALL PLANTERS TO BE FIELD PLACED. COORDINATE WITH LANDSCAPE DESIGNER TO FIELD VERIFY LOCATIONS.

INSTALL:
152 LF - 8" DECORATIVE METAL EDGING
AROUND 32'X6' PLANTING BEDS

INSTALL:
INTERSECTION BULBOUT
2 - ADA RAMPS
CURB AND GUTTER
SIDEWALK

[illegible]

THE SEAL APPEARING ON THIS DOCUMENT WAS AUTHORIZED BY
KEVIN SWEAT
LIC. # 92023

CERTIFY THAT THESE DRAWINGS ARE COMPLETE, ACCURATE AND ADEQUATE FOR THEIR INTENDED PURPOSES, INCLUDING CONSTRUCTION, BUT ARE NOT AUTHORIZED FOR CONSTRUCTION UNTIL FORMAL CITY APPROVAL.

CITY OF AUSTIN, TEXAS
PUBLIC WORKS DEPARTMENT
ENGINEERING SERVICES DIVISION



NOTES	NAME	DATE
SURVEY BY		
DRAWN BY	DS	
DESIGNED BY	CN	
CHECKED BY	ESD	
REVIEWED BY	KS	

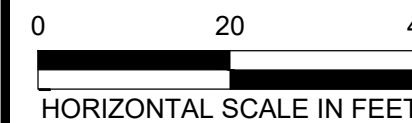

GP-2020-____.PWD

12/22/2020 11:24 AM	SWEAT, KEVIN	C:\USERS\KEVIN\LOCAL SETTINGS\LOCAL APPDATA\TEMP\122220201124AM\PROJECTS\REDRIVER IMPROVEMENTS\CAD\PRODUCTION FILES\DWG\RRDLC-SI\PLANDWG_COA PDF 22X34_COA PLOT STYLES.STB
---------------------	--------------	--

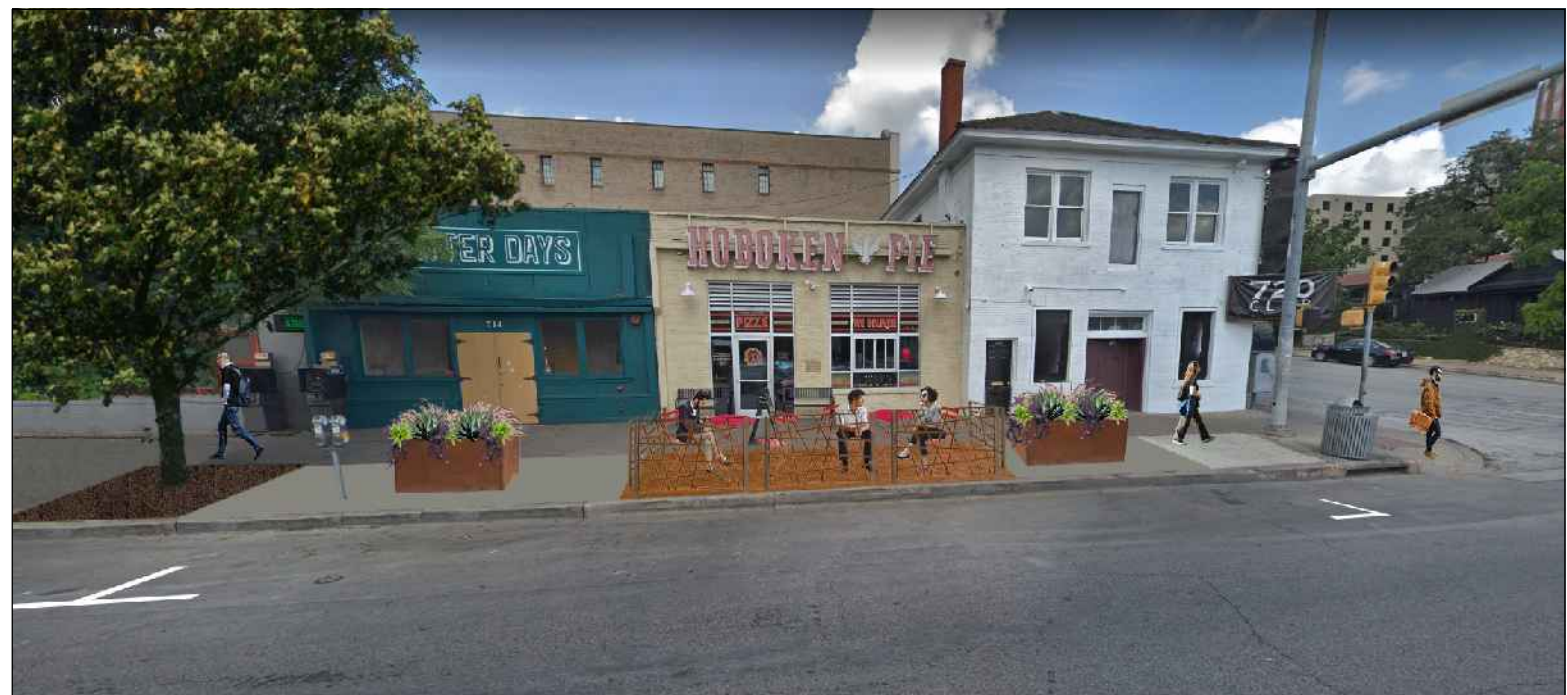

INSTALL:
SIDEWALK
CURB AND GUTTER
6 - 8' x 3' x 3' RAISED PLANTERS

INSTALL:
INTERSECTION BULBOUT
2 - ADA RAMPS
CURB AND GUTTER
SIDEWALK

INSTALL:
INTERSECTION BULBOUT
2 - ADA RAMPS
CURB AND GUTTER
SIDEWALK

INSTALL:
3 - 8' x 3' x 3' RAISED PLANTERS

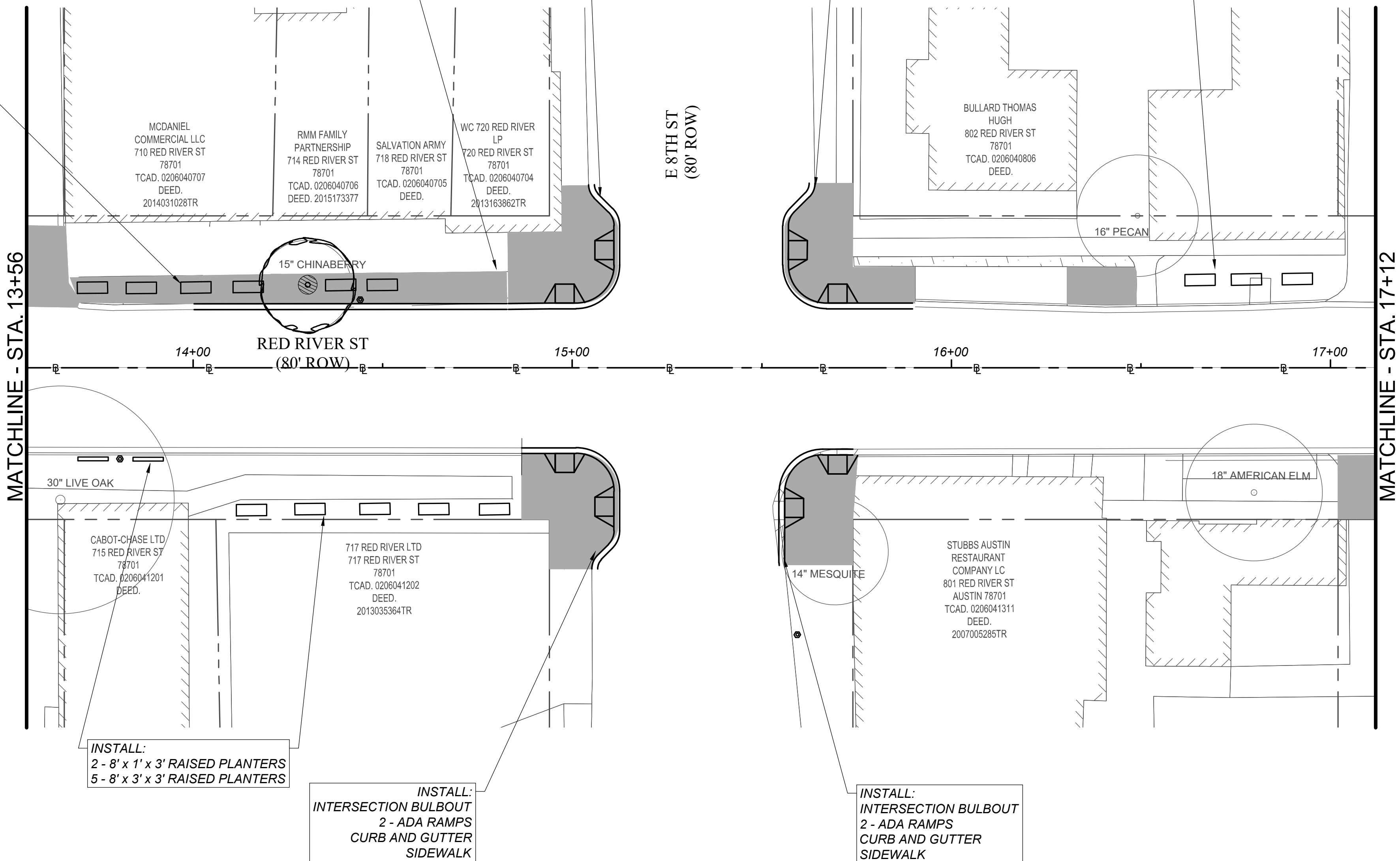

- NOTES:
- PROJECT ENGINEER TO FIELD VERIFY EXTENTS OF EXISTING CURB AND GUTTER, SIDEWALK, AND DRIVEWAYS FOR REMOVAL AND REPLACEMENT.
 - ALL GRADING AND PEDESTRIAN IMPROVEMENTS SHALL COMPLY WITH ADA REQUIREMENTS. COORDINATE WITH PROJECT ENGINEER TO FIELD VERIFY LINES, GRADES AND LEVELS.
 - ALL PLANTERS TO BE FIELD PLACED. COORDINATE WITH LANDSCAPE DESIGNER TO FIELD VERIFY LOCATIONS.



THE SEAL APPEARING ON THIS DOCUMENT WAS AUTHORIZED BY KEVIN SWEAT LIC. # 92023

I CERTIFY THAT THESE DRAWINGS ARE COMPLETE, ACCURATE AND ADEQUATE FOR THEIR INTENDED PURPOSES, INCLUDING CONSTRUCTION, BUT ARE NOT AUTHORIZED FOR CONSTRUCTION UNTIL FORMAL CITY APPROVAL.

CITY OF AUSTIN, TEXAS
PUBLIC WORKS DEPARTMENT
ENGINEERING SERVICES DIVISION

RED RIVER
ENHANCEMENT

PROPOSED SITE PLAN
(SHEET 2 OF 6)



NOTES	NAME	DATE
SURVEY BY		
DRAWN BY	DS	
DESIGNED BY	CN	
CHECKED BY	ESD	
REVIEWED BY	KS	



GP-2020-____.PWD

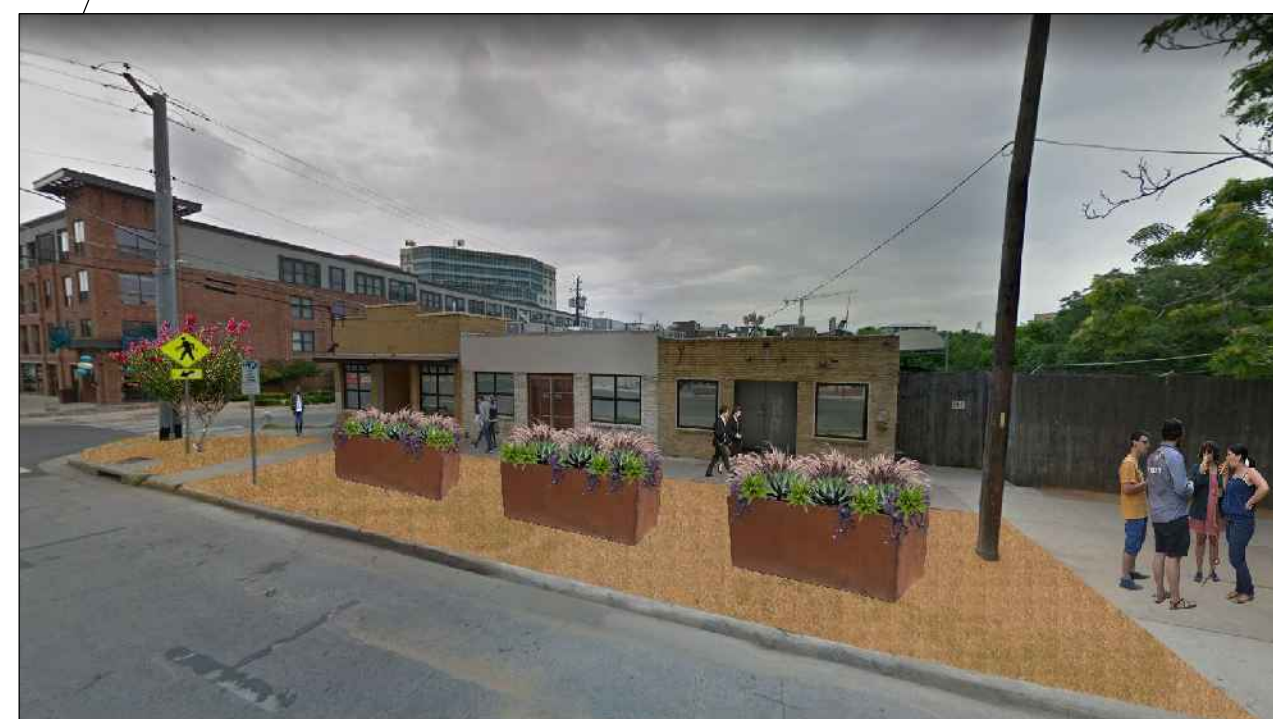
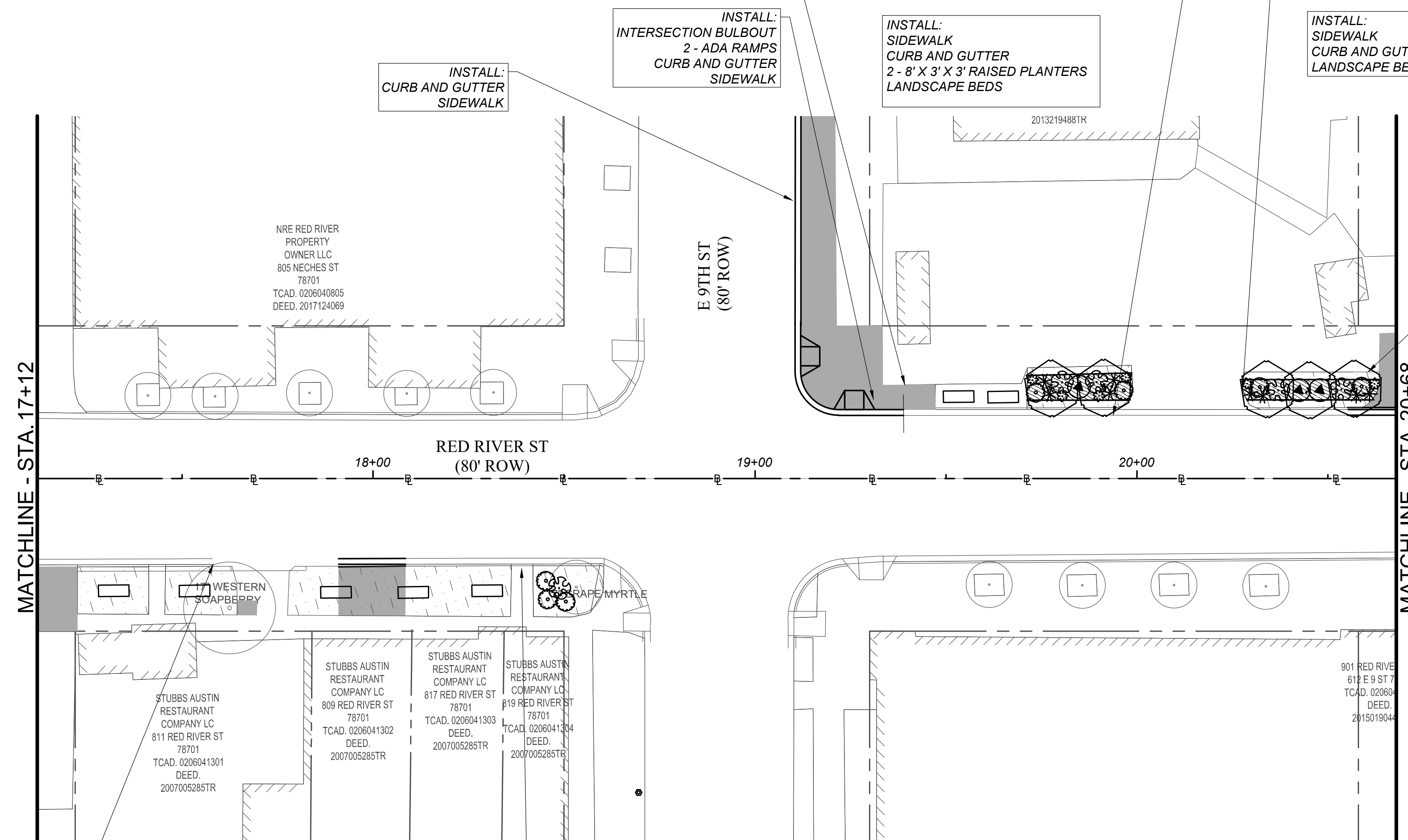

- NOTES:**
1. PROJECT ENGINEER TO FIELD VERIFY EXTENTS OF EXISTING CURB AND GUTTER, SIDEWALK, AND DRIVEWAYS FOR REMOVAL AND REPLACEMENT.
 2. ALL GRADING AND PEDESTRIAN IMPROVEMENTS SHALL COMPLY WITH ADA REQUIREMENTS. COORDINATE WITH PROJECT ENGINEER TO FIELD VERIFY LINES, GRADES AND LEVELS.
 3. ALL PLANTERS TO BE FIELD PLACED. COORDINATE WITH LANDSCAPE DESIGNER TO FIELD VERIFY LOCATIONS.



2020-12-22

THE SEAL APPEARING ON THIS DOCUMENT WAS AUTHORIZED BY KEVIN SWEAT LIC. # 92023

CERTIFY THAT THESE DRAWINGS ARE COMPLETE, ACCURATE AND ADEQUATE FOR THEIR INTENDED PURPOSES, INCLUDING CONSTRUCTION, BUT ARE NOT AUTHORIZED FOR CONSTRUCTION UNTIL FORMAL CITY APPROVAL.

CITY OF AUSTIN, TEXAS
PUBLIC WORKS DEPARTMENT
ENGINEERING SERVICES DIVISION

RED RIVER
ENHANCEMENT

PROPOSED SITE PLAN
(SHEET 3 OF 6)

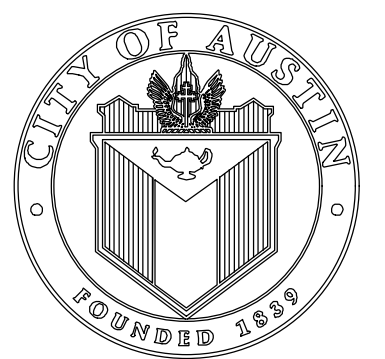

NOTES	NAME	DATE
SURVEY BY		
DRAWN BY	DS	
DESIGNED BY	CN	
CHECKED BY	ESD	
REVIEWED BY	KS	

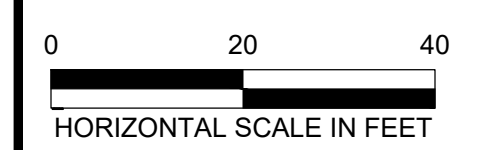

GP-2020-____.PWD



INSTALL:
SIDEWALK
CURB AND GUTTER
LANDSCAPE BEDS

INSTALL:
SIDEWALK
CURB AND GUTTER
1 - 8' X 3' X 3' RAISED PLANTERS
LANDSCAPE BEDS

INSTALL:
INTERSECTION BULBOUT
2 - ADA RAMPS
CURB AND GUTTER
SIDEWALK

INSTALL:
INTERSECTION BULBOUT
2 - ADA RAMPS
CURB AND GUTTER
SIDEWALK

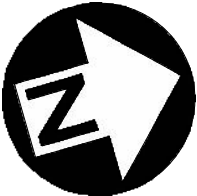
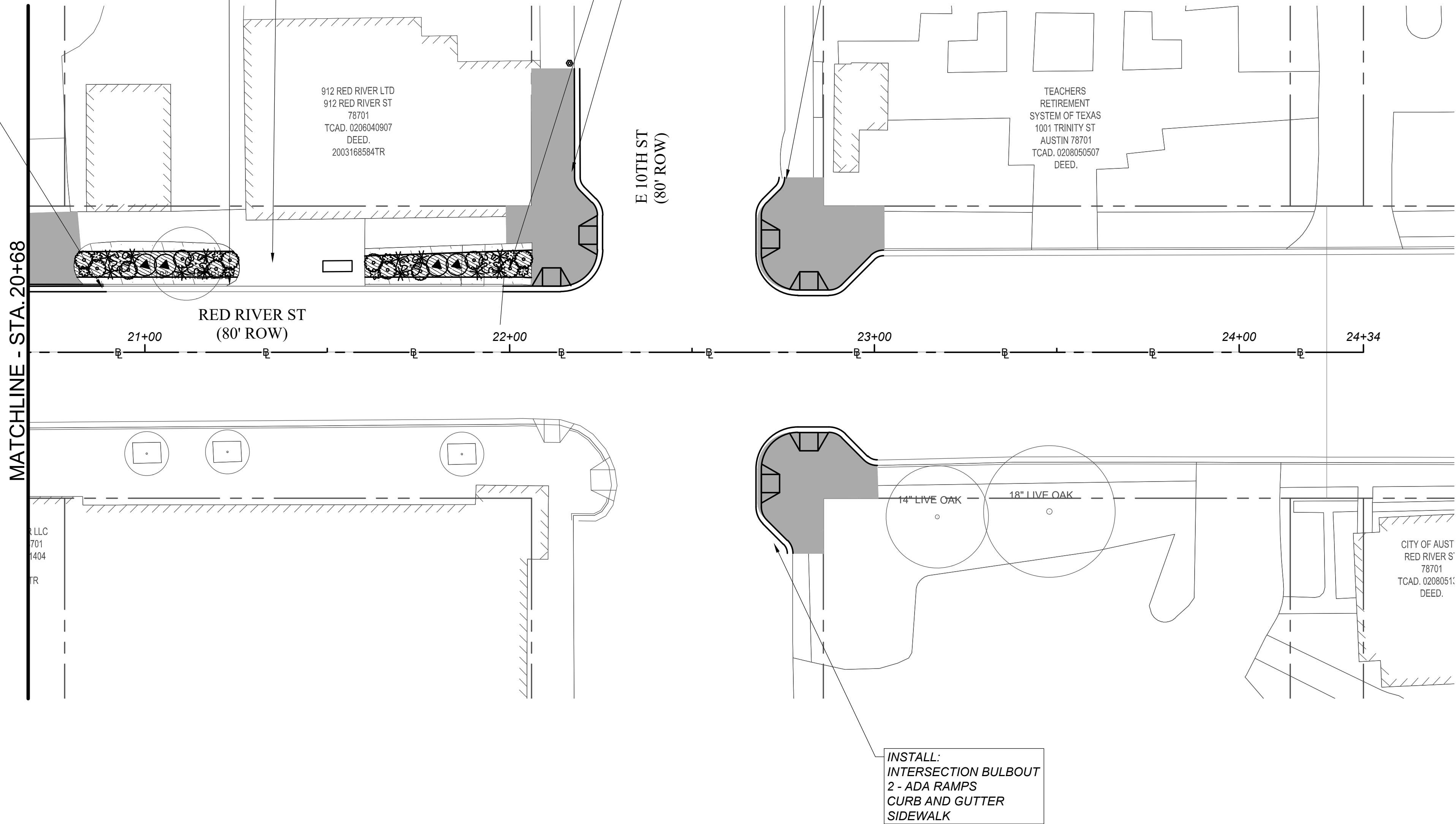

- NOTES:
- PROJECT ENGINEER TO FIELD VERIFY EXTENTS OF EXISTING CURB AND GUTTER, SIDEWALK, AND DRIVEWAYS FOR REMOVAL AND REPLACEMENT.
 - ALL GRADING AND PEDESTRIAN IMPROVEMENTS SHALL COMPLY WITH ADA REQUIREMENTS. COORDINATE WITH PROJECT ENGINEER TO FIELD VERIFY LINES, GRADES AND LEVELS.
 - ALL PLANTERS TO BE FIELD PLACED. COORDINATE WITH LANDSCAPE DESIGNER TO FIELD VERIFY LOCATIONS.



KS

2020-12-22
THE SEAL APPEARING ON THIS DOCUMENT WAS AUTHORIZED BY KEVIN SWEAT LIC. # 92023

I CERTIFY THAT THESE DRAWINGS ARE COMPLETE, ACCURATE AND ADEQUATE FOR THEIR INTENDED PURPOSES, INCLUDING CONSTRUCTION, BUT ARE NOT AUTHORIZED FOR CONSTRUCTION UNTIL FORMAL CITY APPROVAL.

CITY OF AUSTIN, TEXAS
PUBLIC WORKS DEPARTMENT
ENGINEERING SERVICES DIVISION

RED RIVER
ENHANCEMENT

PROPOSED SITE PLAN
(SHEET 4 OF 6)



NOTES	NAME	DATE
SURVEY BY		
DRAWN BY	DS	
DESIGNED BY	CN	
CHECKED BY	ESD	
REVIEWED BY	KS	

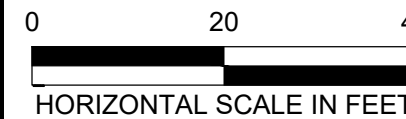

GP-2020-____.PWD

CS104 22 OF 46

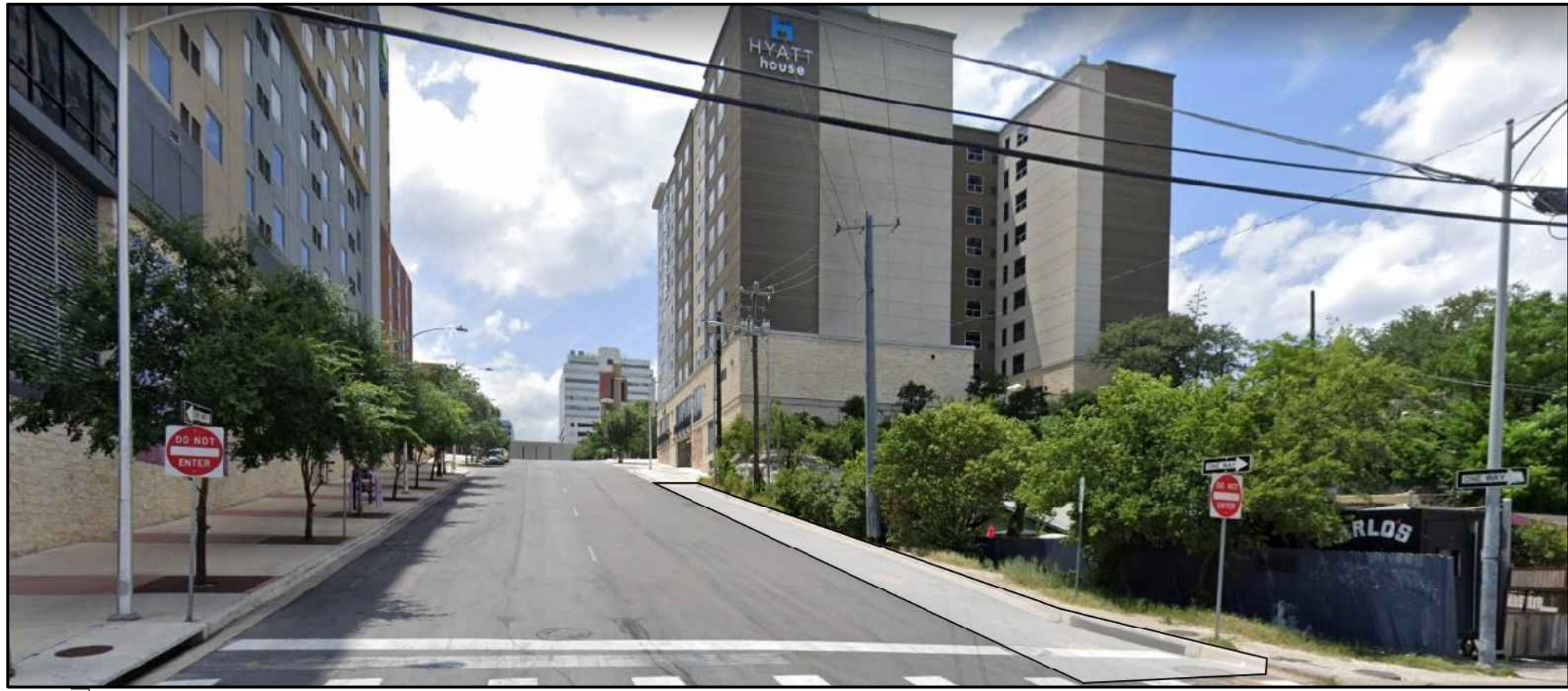

- NOTES:**
1. PROJECT ENGINEER TO FIELD VERIFY EXTENTS OF EXISTING CURB AND GUTTER, SIDEWALK, AND DRIVEWAYS FOR REMOVAL AND REPLACEMENT.
 2. ALL GRADING AND PEDESTRIAN IMPROVEMENTS SHALL COMPLY WITH ADA REQUIREMENTS. COORDINATE WITH PROJECT ENGINEER TO FIELD VERIFY LINES, GRADES AND LEVELS.
 3. ALL PLANTERS TO BE FIELD PLACED. COORDINATE WITH LANDSCAPE DESIGNER TO FIELD VERIFY LOCATIONS.



THE SEAL APPEARING ON THIS
DOCUMENT WAS AUTHORIZED BY
KEVIN SWEAT
H.C. #22282

I CERTIFY THAT THESE DRAWINGS ARE COMPLETE, ACCURATE AND ADEQUATE FOR THEIR INTENDED PURPOSES, INCLUDING CONSTRUCTION, BUT ARE NOT AUTHORIZED FOR CONSTRUCTION UNTIL FORMAL CITY APPROVAL.

CITY OF AUSTIN, TEXAS
PUBLIC WORKS DEPARTMENT
ENGINEERING SERVICES DIVISION

RED RIVER ENHANCEMENT

PROPOSED SITE PLAN
(SHEET 5 OF 6)



NOTES	NAME	DATE
SURVEY BY		
DRAWN BY	DS	
DESIGNED BY	CN	
CHECKED BY	ESD	
REVIEWED BY	KS	

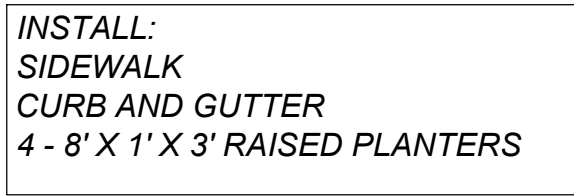
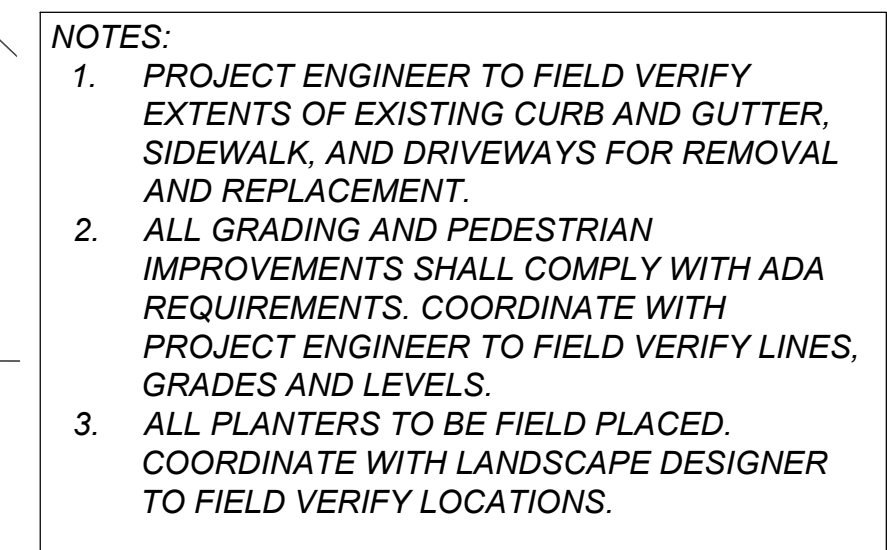

GP-2020-____.PWD

[illegible]

